

64H PIXEL 10MM OUTDOOR STANDARD LED TICKER

FRONT MOUNTING AND FRONT SERVICE

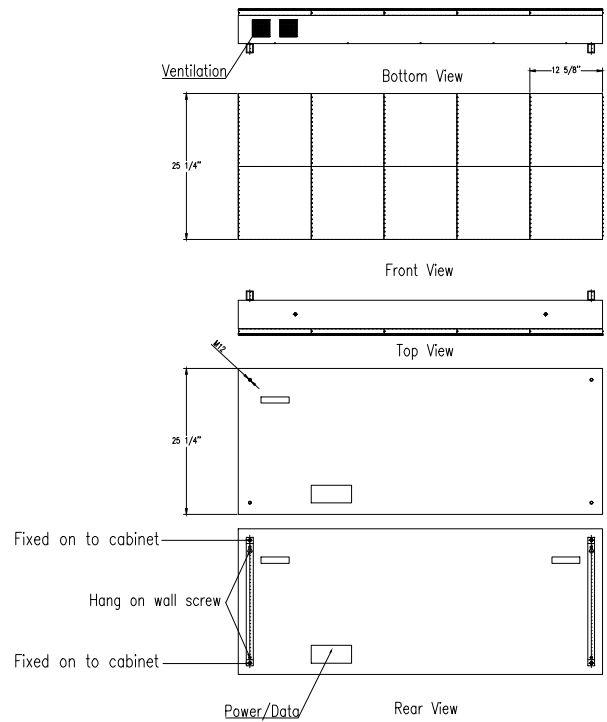

TYPE 1 MOUNTING: HANDY HANG

SPECIFICATIONS:

- PIXEL PITCH : .39" (10mm)
- COLOR: RGB (FULL COLOR)
- CHARACTER HEIGHT: 25.2 INCH (64H)
- ELECTRICAL REQUIREMENTS: 120VAC-220VAC/SINGLE PHASE MANUALLY SWITCHED
 @ 120 VAC OUTDOOR - 150 WATTS/FT
 POWER INPUT: POWER CORD
- DATA: XPICO WIFI OR ETHERNET
- CHASSIS METAL & FINISH: ALUMINIUM WITH EXTRUDED BLACK POWDER COAT
- SIGN MOUNTING: WALL MOUNT
- WEIGHT : 15.2 LBS/FT

STANDARD CABINET DESIGN

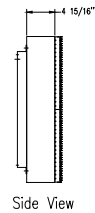

Side View

64px P10 Front service Chassis 2:1

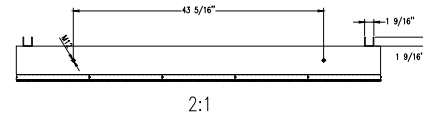

2:1

INSTALLATION EXAMPLE

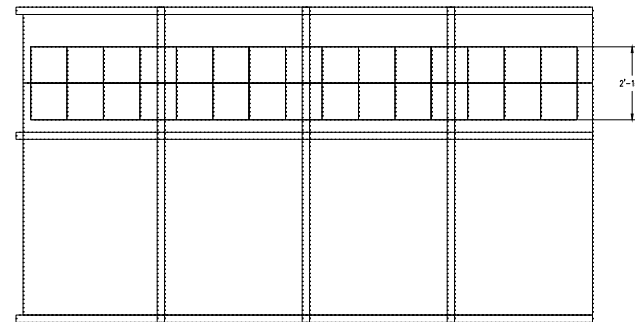

2 1/8"

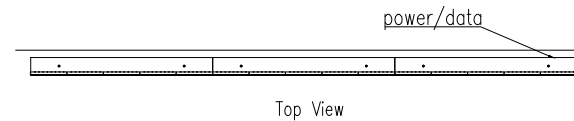

Top View

LEAVE SPACE FOR AIR CIRCULATION

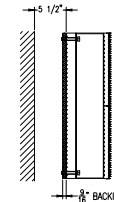

Side View

2:1

REMOVE THE MODULE, TIGHTEN TAPPING SCREW (M12 * 80) VIA THE RUBBER TAP THEN INSTALLATION HOLE INSIDE THE CABINET TO LOCK IT ON THE BACKING DESIGNATED BY THE CONTRACTOR.

TYPE 2 MOUNTING: TAPING SCREW WITH BACKING



COMPANY _____ TITLE _____

SIGNED _____ DATE _____

PROJECT
RISETICKER SHOP DRAWING

TITLE
LED TICKER DISPLAY (64 PIXEL-10MM)

DRAWING NO
RISETICKER-6410FO

SCALE : 1:1	DRAWN BY: JHW	DATE : 4 / 17 /23
----------------	------------------	----------------------