



## 55" LED LCD Display

**Manufacturer:** NEC

**Model:** X551S

- Weight: 52.7 lbs
- Dimensions: 49.4" (w) x 28.6" (h) x 1.7" (d)
- Power Supply: 3.2 – 1.2A @ 100-240VAC, 50/60Hz
- Native Resolution: 1920 x 1080
- Contrast Ratio: 4000:1
- Operating Temperature: 5 – 40 C
- Brightness: 600 cd/m<sup>2</sup> (max), 500cd/m<sup>2</sup> (typ)
- Audio: Internal Speaker 10W, External Speaker Jack 15W+15W (8 ohm), Output, RCA(L/R)

## Integrated Rise Engine

- Weight: 3.3 lbs
- Power Consumption: 38W max via internal connection
- Operating System: Windows 7
- RAM: 2GB
- Processor: Intel Core i5 2.4GHz
- Hard Driver: 160GB
- Graphics Card: Intel 3400 Chipset
- Connection: HDMI via internal connection
- Output: Display Port
- USB: 2 (USB 2.0)



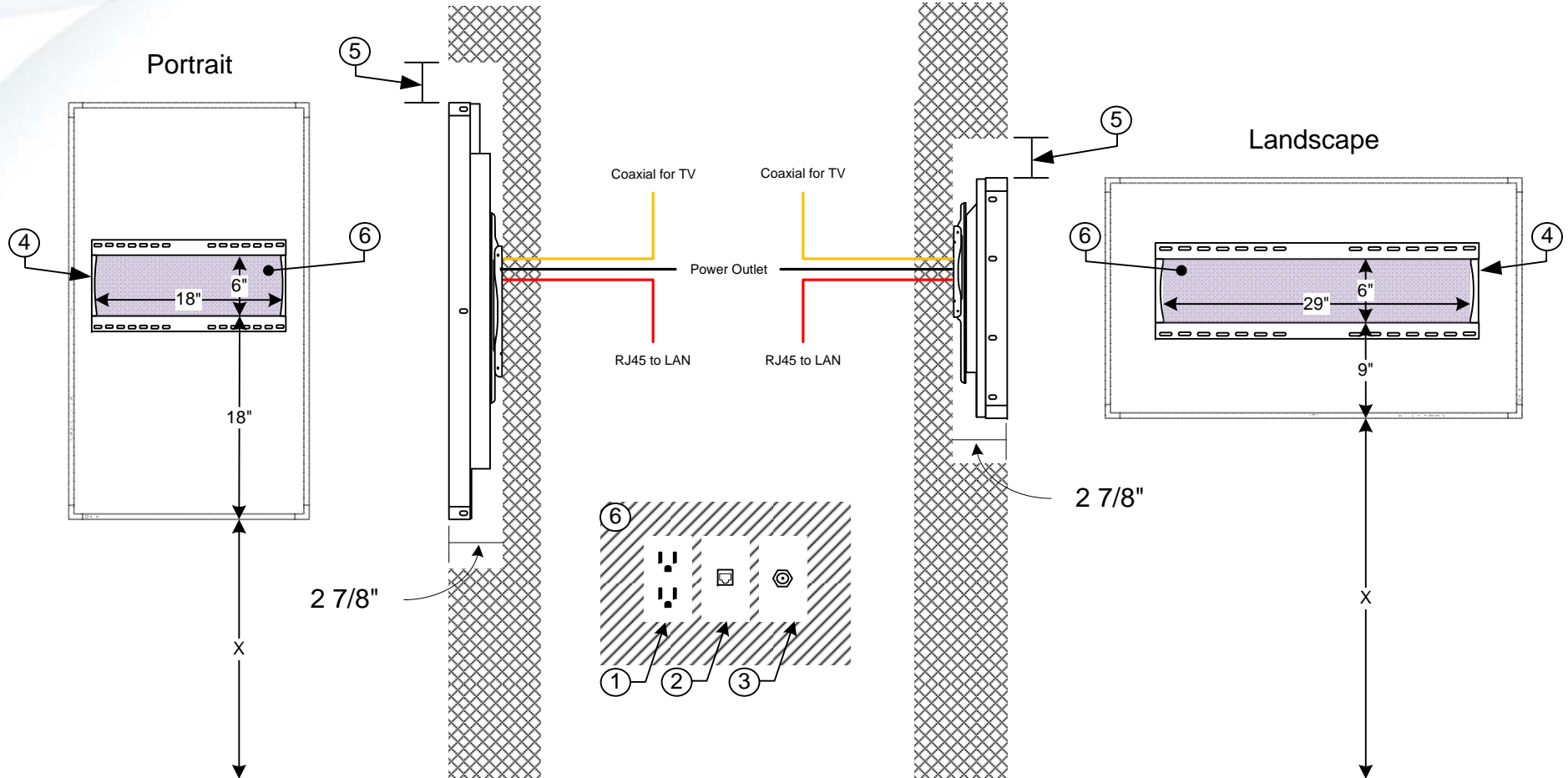

X" = Desired distance from the floor to the bottom of the LCD when installed.

X" = Desired distance from the floor to the bottom of the LCD when installed.

**Comments:**

- ① Flush 120VAC Outlet – by others
- ② Flush CATx Outlet (LAN) – by others
- ③ Flush Coaxial Outlet (TV) – by others
- ④ Wall Mounting Bracket
- ⑤ 4" opening around display for recessed installations to allow for adequate ventilation
- ⑥ Locate outlets in shaded region

**Front View**

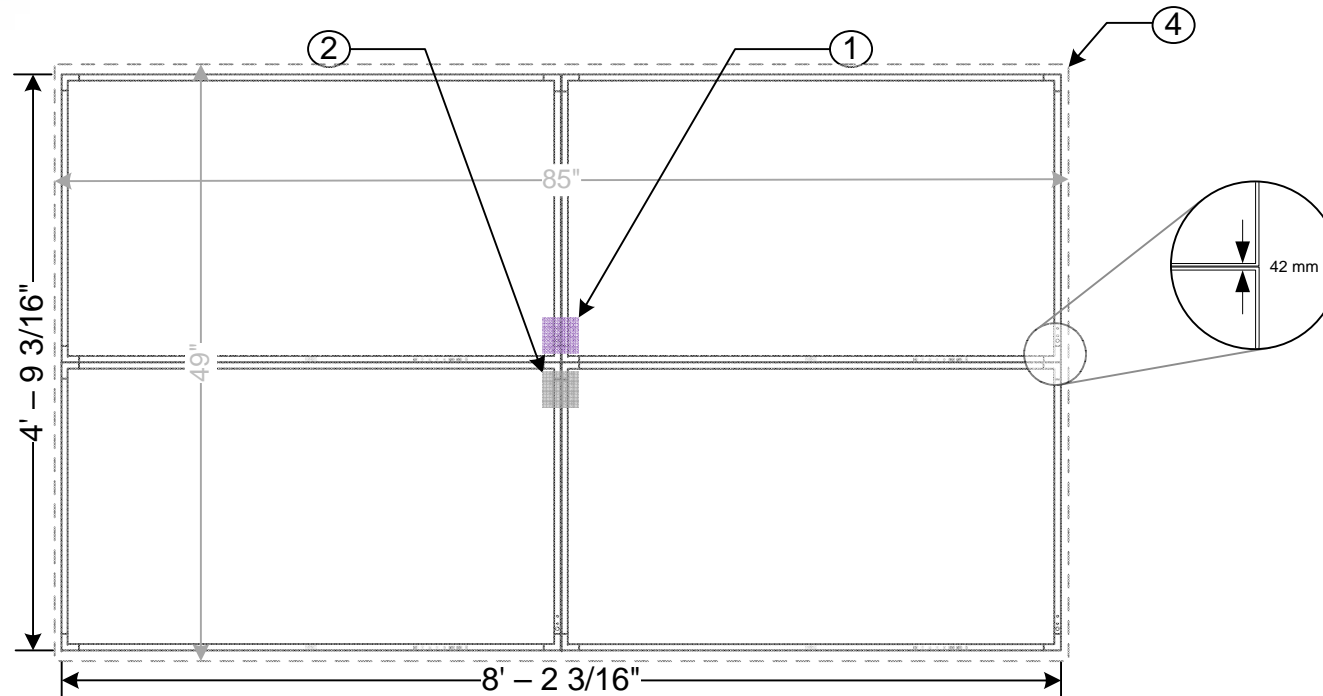

**Side View**

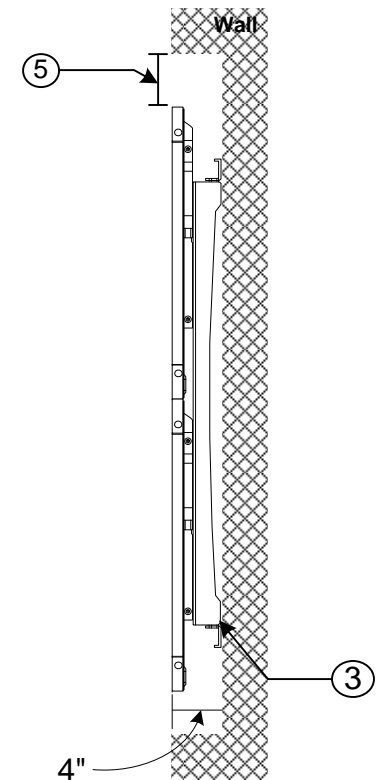

**Technical Specifications**

- **Weight:** 230 lbs
- **Dimensions:** 98.8" (w) x 57.2" (h) x 4" (d)
- **Power Consumption:** 12.8 – 4.8A @ 100-240VAC, 50/60Hz
- **Native Resolution:** 1920 x 1080
- **Contrast Ratio:** 4000:1
- **Operating Temperature:** 5° to 40° C
- **Brightness:** 500 cd/m<sup>2</sup> (typ)

**Overall Specifications**

**Comments:**

- ① Flush 120VAC Outlet – BY OTHERS
- ② 1 Flush CATx Outlet for LAN Connectivity – BY OTHERS
- ③ Wall Mounting Bracket
- ④ Area of wall to be reinforced – 1/2" plywood recommended – BY OTHERS
- ⑤ 4" opening around display for recessed installations to allow for adequate ventilation – BY OTHERS



CLIENT FIREWALL



CLIENT LAN



### Browser Requirements:

All browsers supported. Internet Explorer required the Google Chrome Frame Plugin

### Network Requirements:

From LAN, Integrated Rise Engine requires access to the following:

- <http://rvauser.appspot.com>
- <http://rvagadgets.appspot.com>
- <http://rvashow.appspot.com>
- <http://rvaserver.appspot.com>